

Field Seam Comparisons

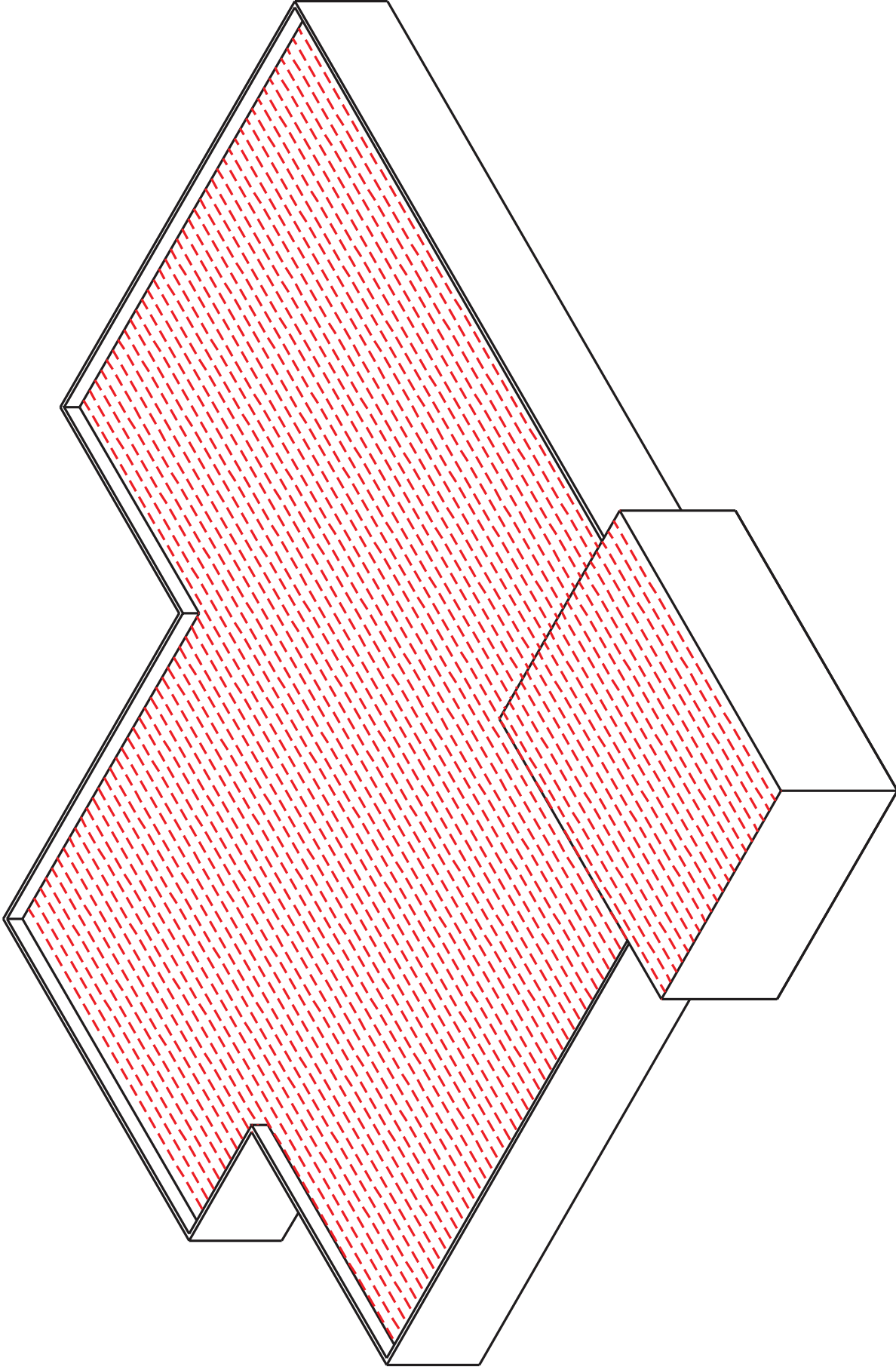

**Modified Cap Sheet
3' Wide Roll-Good System
Linear Feet of Field Seams – 13,626**

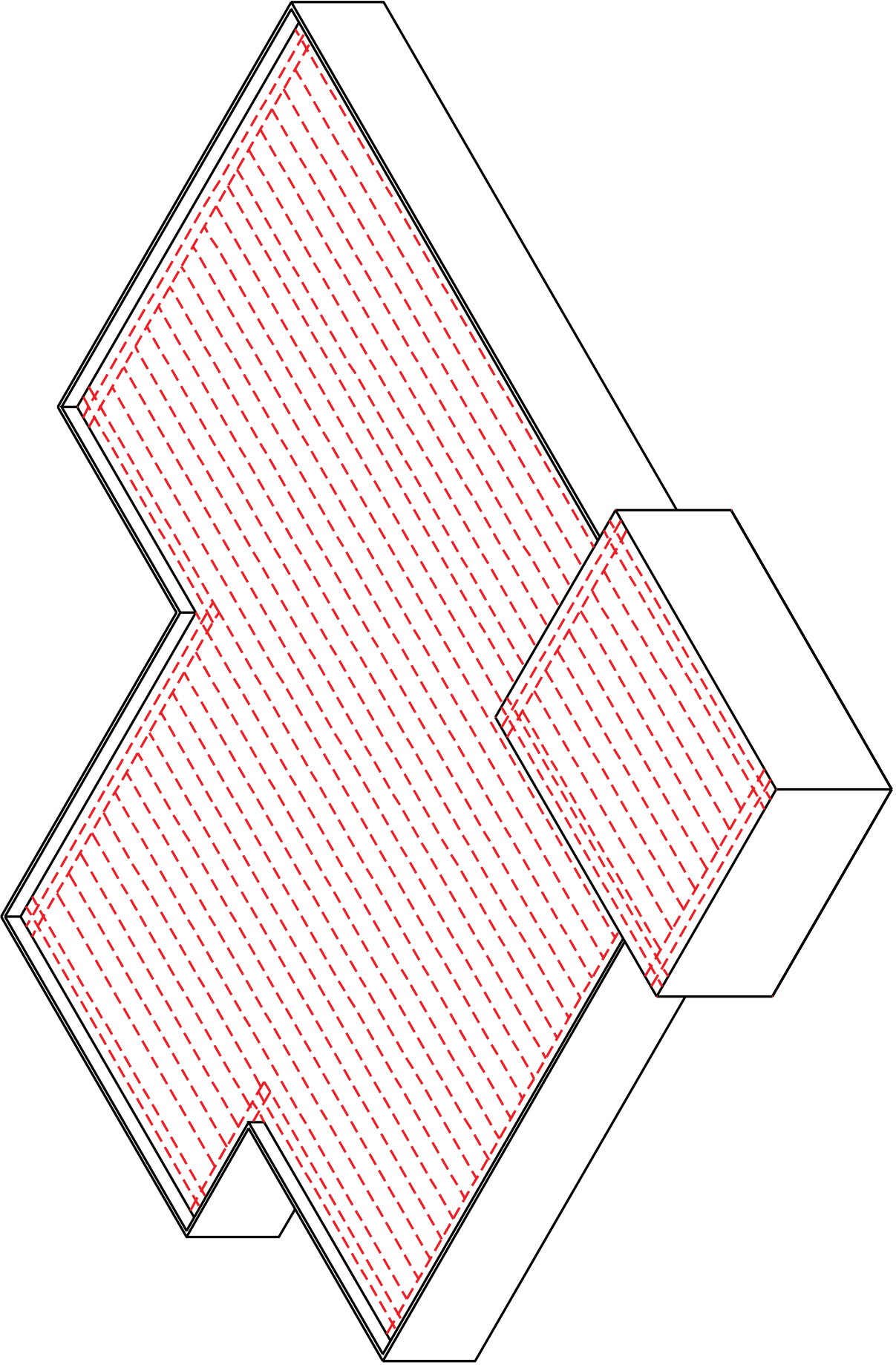

**6' Wide Roll-Good Systems
Linear Feet of Field Seams – 7,968**

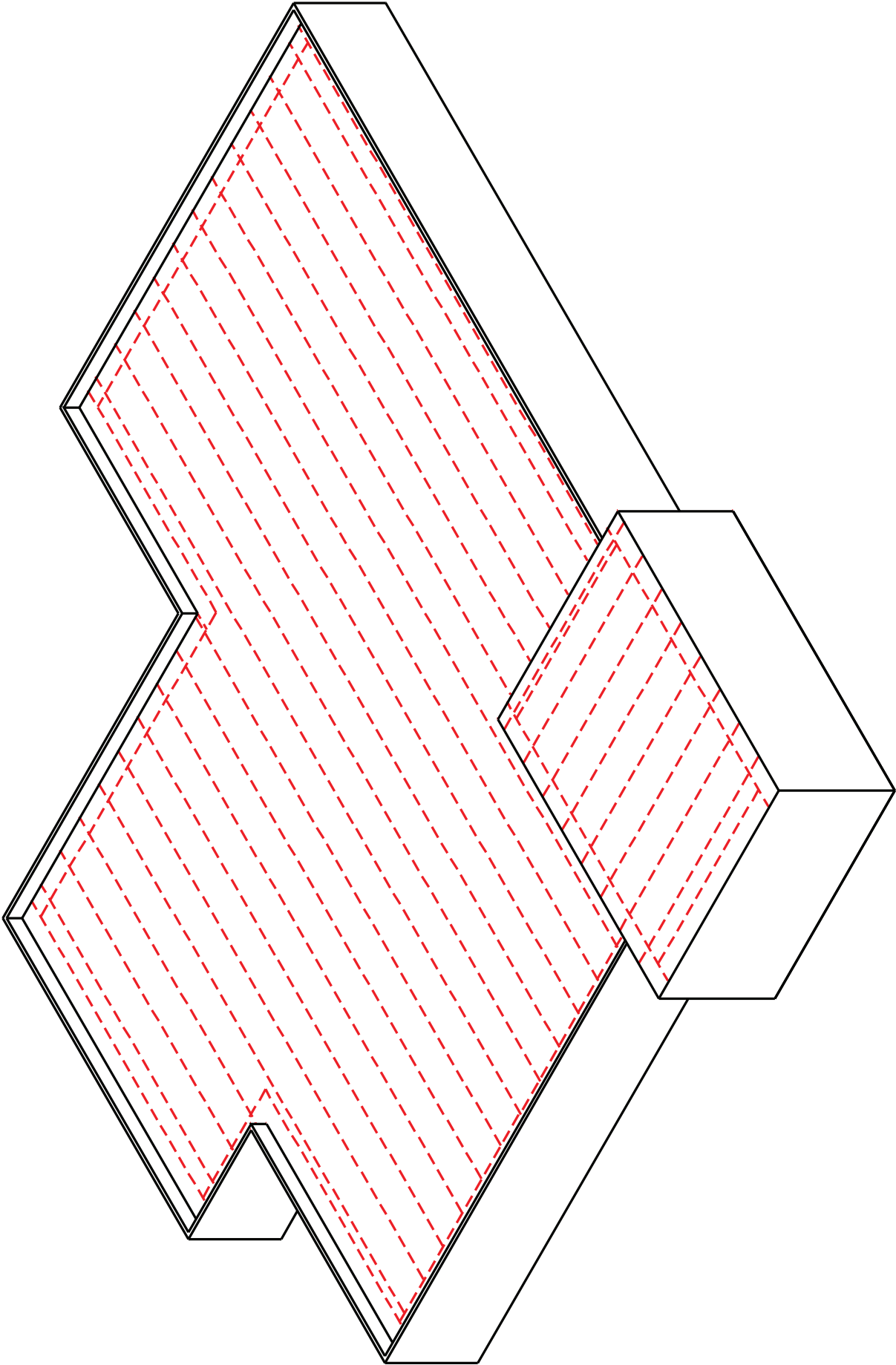

**10' Wide Roll-Good Systems
Linear Feet of Field Seams – 5,130**

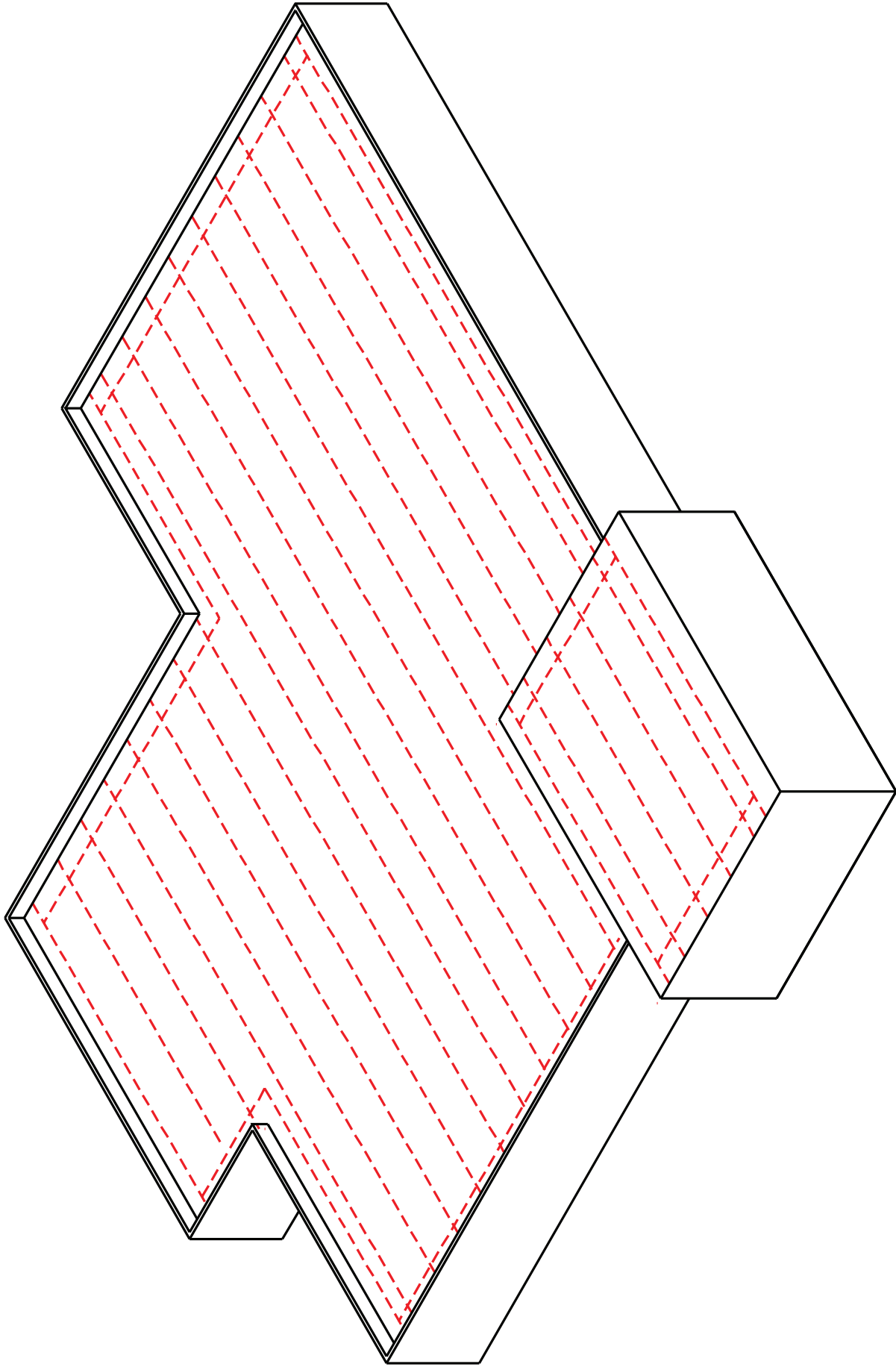

**12' Wide Roll-Good Systems
Linear Feet of Field Seams – 4,209**

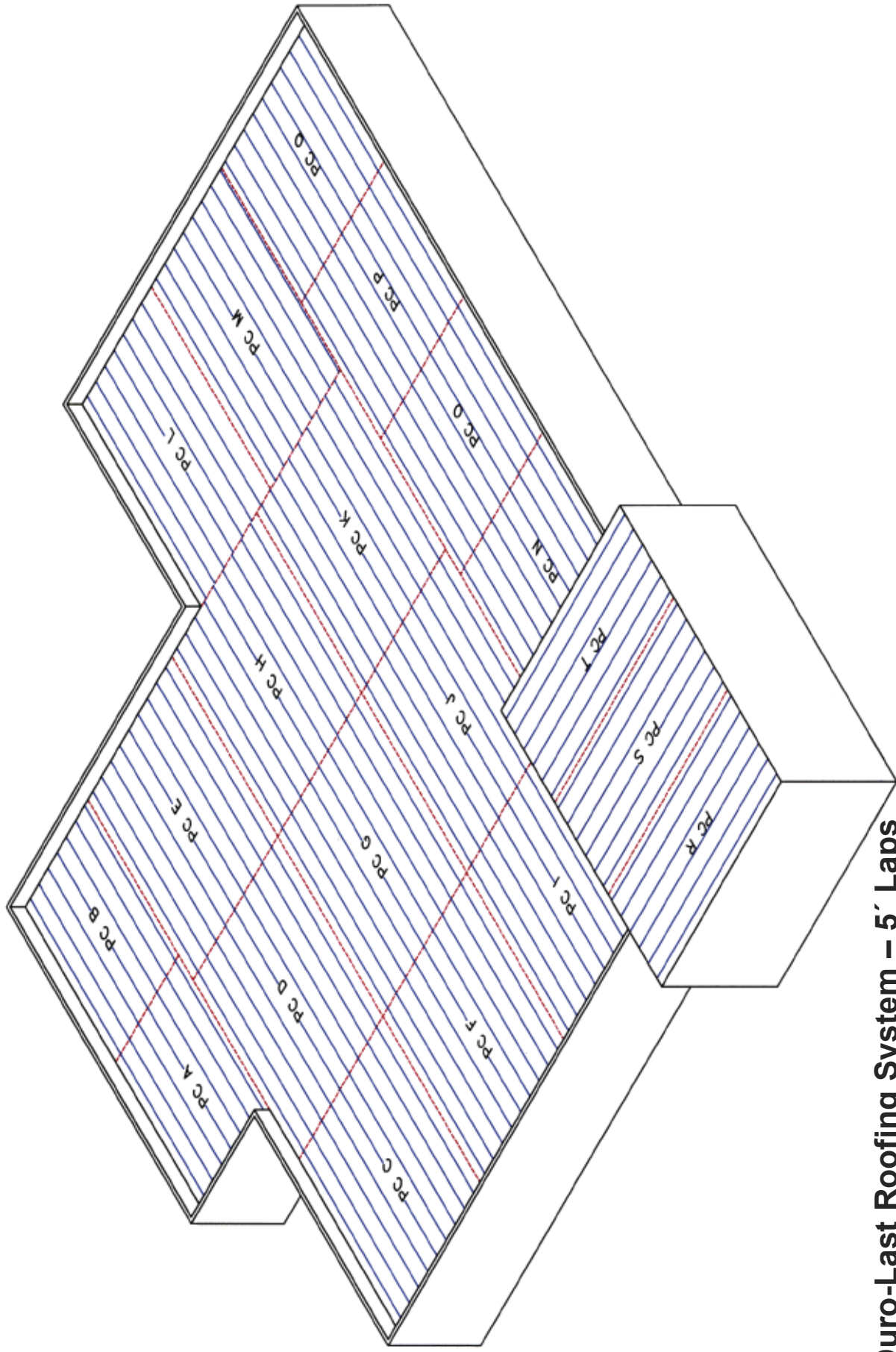

**Duro-Last Roofing System – 5’ Laps
 Prefabricated Membrane Sheets
 Linear Feet of Field Seams – 1,278
 (Solid blue lines represent Duro-Last factory seams)**

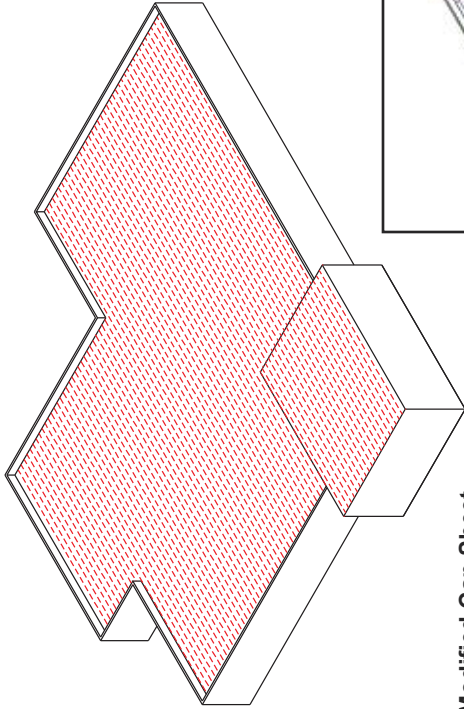

Modified Cap Sheet
3' Wide Roll-Good System
Linear Feet of Field Seams – 13,626

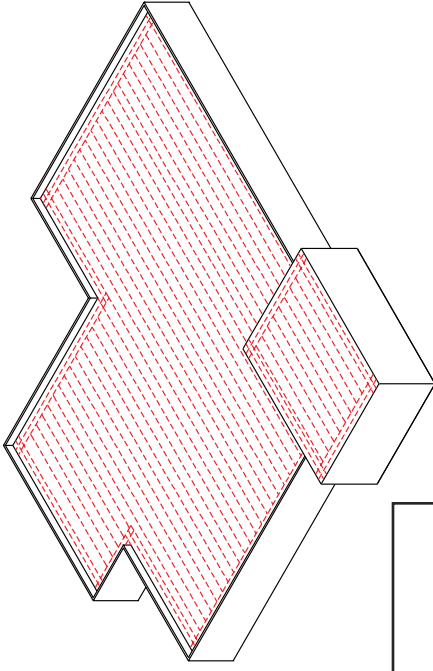

6' Wide Roll-Good Systems
Linear Feet of Field Seams – 7,968

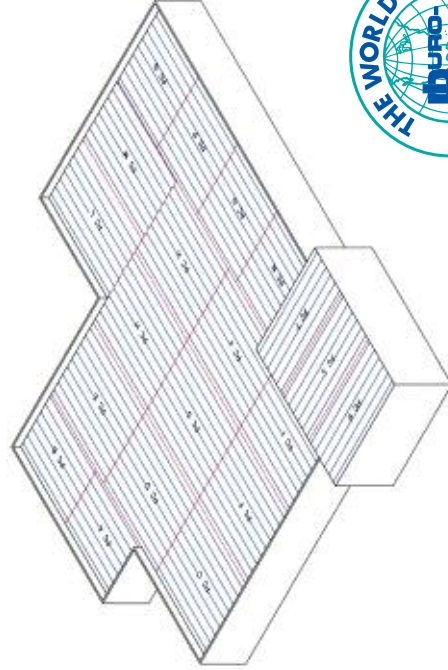

Duro-Last Roofing System – 5' Laps
Prefabricated Membrane Sheets
Linear Feet of Field Seams – 1,278
(Solid blue lines represent Duro-Last factory seams)



10' Wide Roll-Good Systems
Linear Feet of Field Seams – 5,130

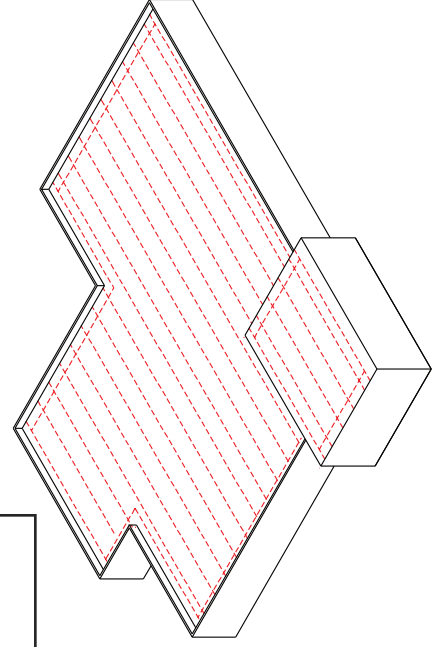

12' Wide Roll-Good Systems
Linear Feet of Field Seams – 4,209



DURO-LAST MANUFACTURING FACILITIES

525 Morley Dr.
Saginaw, MI 48601
800-248-0280
Fax: 800-432-9331

111 N. Valley Dr.
Grants Pass, OR 97526
800-356-6646
Fax: 866-258-2858

1409 E. SADC Ave.
Sigourney, IA 52591
888-500-3574
Fax: 888-501-3574

6200 I-55 South
Jackson, MS 39272
800-434-3876
Fax: 866-602-4387

www.duro-last.com